

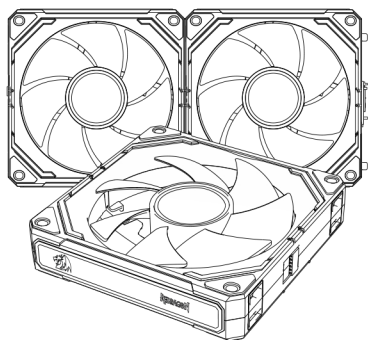

GC-F012 ARGB FAN

Installation Guide



ACCESSORIES

ARGB Fan



1PACK:1 PCS

PACKAGE:3PCS

Rhythmic Controller



PACKAGE:1PCS

Controller



1PACK:1 PCS

PACKAGE:1 PCS

Fan Screw



1PACK:4 PCS

PACKAGE:12 PCS

Water Cooling Screw



1PACK:4 PCS

PACKAGE:12 PCS

Cable Installation And Removal

Power Cord Installation

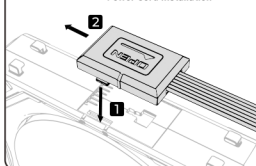

Power Cord Disassembly

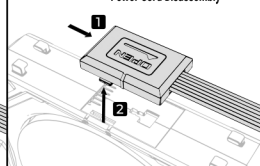

1

Fan Assembling/Removal

Fan Installation

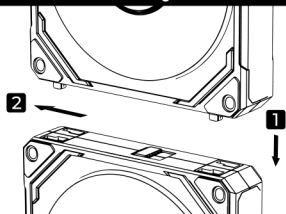

Fan Disassembly

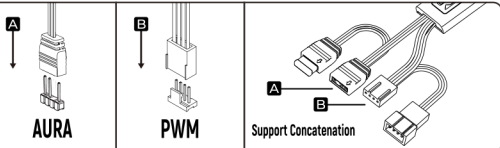
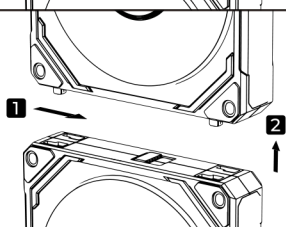

2

Mini Controller Instructions

M KEY:

Click to switch to the next lighting mode, cycling through all modes;
-in the single-color constant brightness mode, long press the "M" key to enter/exit music mode, and in music mode, click to switch the type of music mode.

S KEY:

Click to switch the light speed, cycling through 5 levels;
-in the single-color constant brightness mode, click to adjust the light brightness, cycling through 4 levels;
-in music mode, press the S key to adjust the sensitivity, cycling through 3 levels;
-in any mode, long press the S key for 2 seconds to turn off the light.
(After the light is turned off, press the M or C key to restore the light.)



C KEY:

In any mode, click the C key to switch to the single-color constant brightness mode, and click again to switch the color, cycling through 7 colors.

RESET KEY:

(If the "RESET SW" connector of the MINI controller is connected to the "RESET SW" connector on the case)

-Click the RESET key on the case to switch modes (including music mode);
-long press the RESET key on the case for 2 seconds to cycle through single-color mode, multi-color mode, music mode, and turning off the light in sequence.

Sound Rhythm:

Built-in listening function, automatically recognizes music rhythm to achieve a wonderful interaction between light and music, moving with the sound.

NOTE:

A single connector can connect up to 6 fans at the same time, and one controller can connect up to 10 fans. Overloading the installation may damage the device.

3